

KRYKARD

LES | LIGHTING ENERGY SAVER

**PAYBACK
IN AS LOW AS**
9
MONTHS!
DEPRECIATION
is an added benefit.



krykard lighting energy saver

a cost-effective way to conserve energy of lighting loads without heavy investments or cumbersome changes in light fittings.

With increasing energy tariffs, the energy costs even on account of lighting loads is becoming significant. Numerous methods of saving lighting energy costs without compromising on lighting needs are being considered. Many a times these include heavy investments or expensive and cumbersome changes.

LES offers a simpler solution in conserving Energy on all types of lighting including old fittings with copper chokes, new fittings with electronic chokes, tube-lights, CFLs, etc.

SIGNIFICANT BENEFITS

LES for...

- ✦ Old Lighting installations with copper chokes } savings of up to **25%**
- ✦ Lighting with a combination of Electronic Ballasts and Copper Chokes } savings of up to **20%**
- ✦ Lighting with Electronic Ballasts/ T5 tube lights } savings of up to **15%**

Also works on Sodium Vapour Lamps, Mercury Vapour Lamps and Metal Halide Lamps

ENERGY SAVING

- Saves up to 25% energy
- Works effectively on all types of lighting
- Improves PF reducing cable losses
- Reduces kVA Demand

PROTECTION

- Increases lamp life and reduces replacement costs
- Reduces THD on current fixtures that generate harmonics

QUALITY OF LIGHTING

- Ensures consistency of lighting which enables better productivity

THE KRYKARD LES CONCEPT

LES is a device that saves energy by maintaining the power delivered to the lighting loads at an optimum voltage, without visibly compromising on the quality of lighting (Lumen output) or comfort.

All types of lamps (except incandescent bulbs) have a non-linear curve for power consumption and lumen delivered. Depending on the type of lamp, about 20% lower wattage results in 5 to 10% lumen drop, which is not easily perceived by the naked eye.

Appropriate power supply to lighting loads also results in improved power factor and reduced harmonics.

KRYKARD LES comes with a Load Manager to display kW & kWh among other electrical parameters, to know the energy consumption patterns with or without LES, thereby instantaneously quantifying savings in energy.

USAGES | Offices, Commercial complexes, Hospitals, Educational Institutes, Research laboratories, Residential complexes, Industries, Campus Lighting

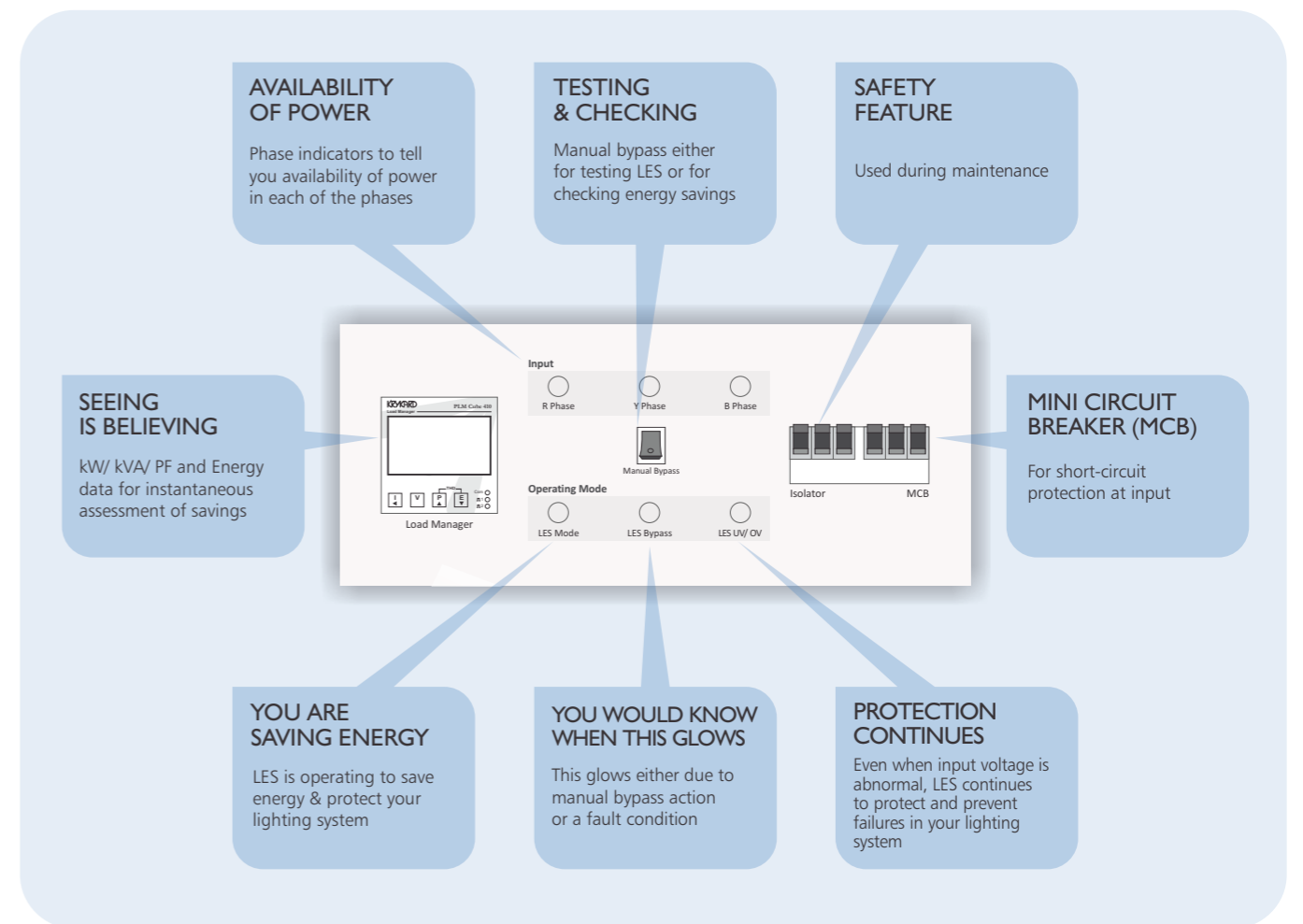

SPECIFICATIONS

Specification	Wide Range Model	Regular Range Air-cooled Model	Regular Range Oil-cooled Model
Rating	3-ph 9 kVA and above		
Recommended Input Voltage Range	160 - 260 V LN	205 - 255 V LN	
Working Input Voltage Range	150 - 290 V LN	190 - 280 V LN	
Auto Bypass	Yes		
Measurements	V, I, PF, kW, kVA, kVAR, kWh, Hz		
Annunciation LEDs	Input - R, Y, B Operating Mode - LES Mode, LES Bypass, LES UV/OV		
Mounting	Floor mounted on wheels or can be grouted using foundation bolts		
Bypass	Only in case of LES fault/ User selectable Manual bypass		

atandra

measure. protect. conserve

Atandra Energy Private Limited

A - 6, Shanti Apartments, 21 & 22, TTK Road, Alwarpet, Chennai - 600 018

Tel: +91 44 4231 6164 | Fax: +91 44 4231 6165

www.atandraenergy.in | energy@atandra.in

Chennai | Coimbatore | Bengaluru | Hyderabad | Mumbai | Ahmedabad

New Delhi | Madurai | Kochi | Tirupur

OUR DEALER

Revision: December 2014. Specifications are subject to change without prior notice.